

SUBMITTAL DATA SHEET

Wastewater Pumps 1/2 - 2 HP Effluent Pumps



A.Y. McDonald's 1/2 - 2 HP Effluent Pumps handle up to 3/4" solids with 2" discharge. Designed for use in dewatering, septic systems, residential and commercial developments, elevator pit applications.

Model	HP	Volts	Phase	AMPS	Cord Length	Switch
405011EFS	1/2	115	1	13.8	20'	Manual
405012EFS	1/2	230	1	6.9	20'	Manual
410012EFS	1	230	1	10.4	20'	Manual
415012EFS	1 1/2	230	1	12	20'	Manual
420012EFS	2	230	1	14.8	20'	Manual

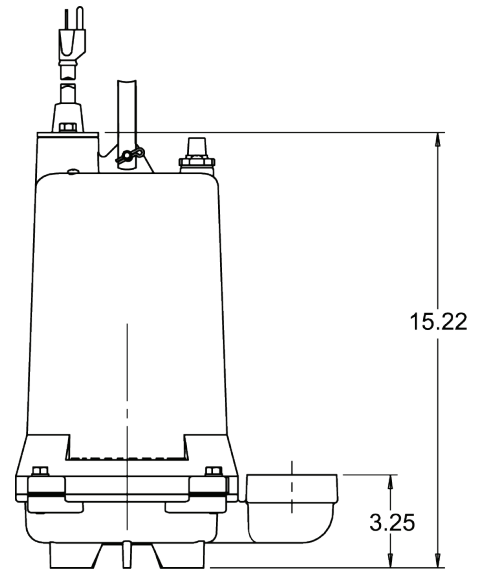
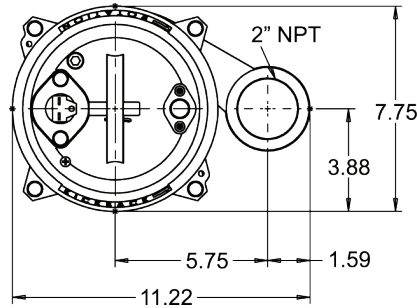

Performance Curve

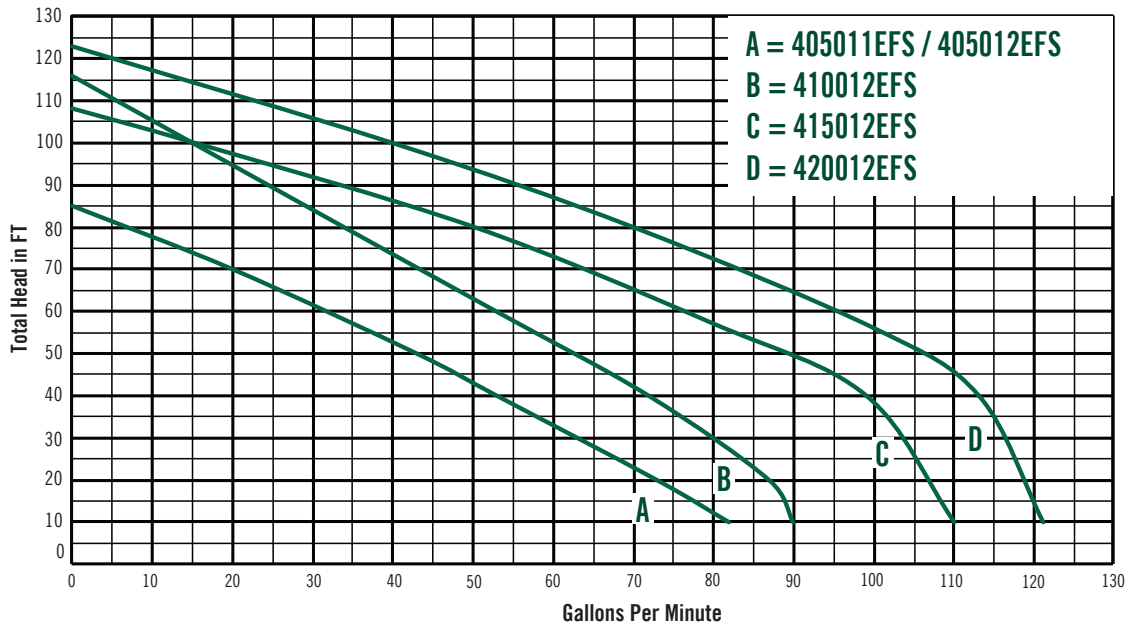

NO-LEAD: The weighted average of the wetted surface of this no-lead product contacted by consumable water contains less than one quarter of one percent (0.25%) lead.



A.Y. McDonald Mfg. Co.
 P.O. Box 508
 Dubuque, IA 52004-0508

Toll Free: 1-800-292-2737
Fax: 1-800-832-9296
Hours: 7:00 a.m. - 5:00 p.m., CST

sales@aymcdonald.com
 www.aymcdonald.com

A.Y. McDonald considers the information on this assembly drawing correct when published. Item and option availability, including specifications, are subject to change without notice.

Submitted by:

SUBMITTAL DATA SHEET

Wastewater Pumps 1/2 - 2 HP Effluent Pumps



Performance

- Heads up to 124' TDH
- Flows up to 122 GPM

Motor

High efficient, 115V or 230V, oil filled, permanent split capacitor motor with upper and lower ball bearings and thermal overload protection

- Constant bearing lubrication
- Maximum motor cooling
- Runs cooler and lasts longer
- Internal overload protection
- Quiet operation
- Fasteners and shaft made from rugged, corrosion resistant stainless steel

Warranty

- 3 Years from date of manufacture

Seal Design

Single, mechanical, oil filled chamber

- Optional double seal series models available that provides additional protection and moisture sensing capabilities
- Optional seal failure feature that will alert you when the seal has failed

Impeller Design

1 or 2 vane cast iron impeller

- Designed to help reduce clogging by foreign material

Power Cord

Sealed entry quick disconnect power cords

- Prevents water from entering the motor housing through a cut cord
- Easy to replace in the field
- Available in lengths up to 100'

Switch

Piggy-back switch design (Single Phase)

- Defective switches can be diagnosed over the phone
- Pump can be operated manually or supplied with other piggy-back switches
- Switch can be replaced

Technical Data

Discharge	2" NPT. vertical standard
Solids Handling	3/4"
Liquid Temperature	140°F (Intermittent)
Motor Housing	Cast Iron
Volute	Cast Iron
Seal Plate	Cast Iron
Impeller	Cast Iron / 1 or 2 Vane
Shaft	Stainless Steel
Shaft Seal (Single Seal)	Single mechanical, carbon rotating face, ceramic stationary face, Buna-N elastomer, 300 series stainless steel hardware
Shaft Seal (Double Seal)	Tandem double mechanical upper & lower, carbon ceramic, Buna-N elastomer, 300 stainless steel hardware
Bearings (Upper & Lower)	Single row, ball, oil lubricated
Hardware	300 Series stainless steel
O-rings	Buna-N
Cord	20' Length standard. Up to 100' available.
Motor (Single Phase)	1/2-2 HP 3450 RPM. 60 Hz, Includes overload protection in the motor, oil filled, class F permanent split capacitor.
Motor (Three Phase)	1/2-2 HP 3450 RPM. 60 Hz, oil filled, requires overload protection to be included in control panel.
Weight	72 lbs (Manual)

NO-LEAD: The weighted average of the wetted surface of this no-lead product contacted by consumable water contains less than one quarter of one percent (0.25%) lead.



A.Y. McDonald Mfg. Co.
P.O. Box 508
Dubuque, IA 52004-0508

Toll Free: 1-800-292-2737
Fax: 1-800-832-9296
Hours: 7:00 a.m. - 5:00 p.m., CST

sales@aymcdonald.com
www.aymcdonald.com

A.Y. McDonald considers the information on this assembly drawing correct when published. Item and option availability, including specifications, are subject to change without notice.

Submitted by: